

The Allegheny News

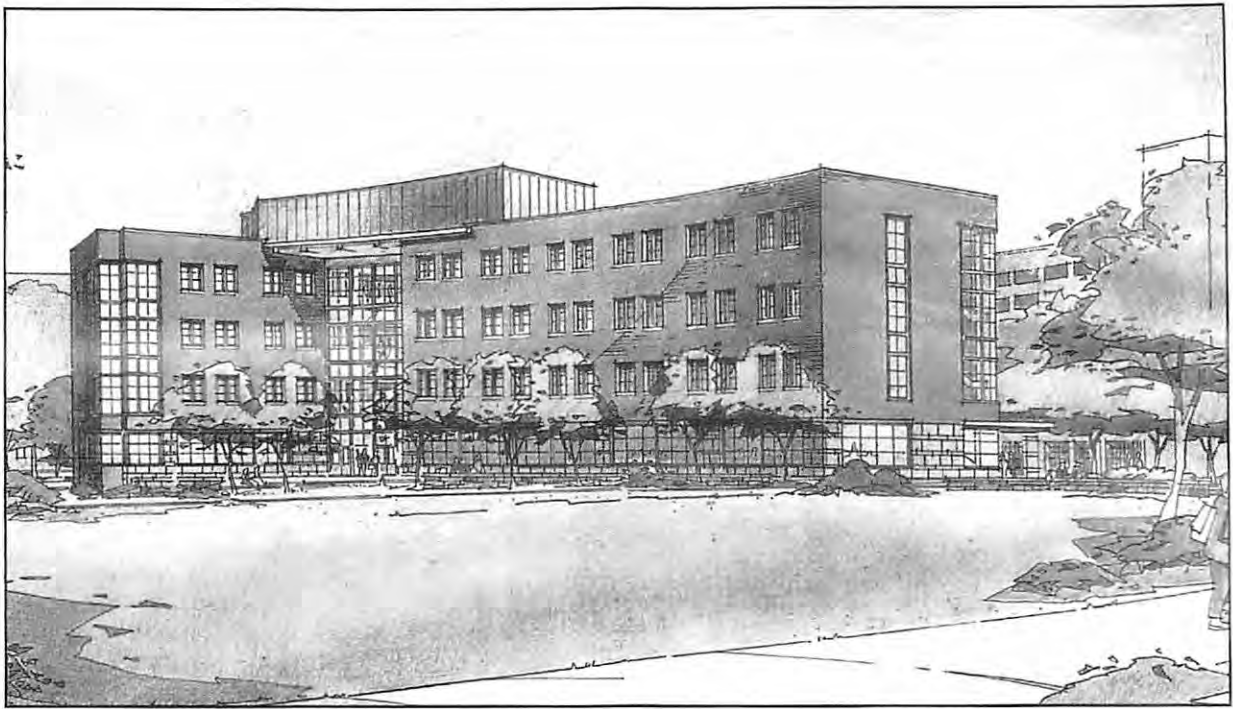

Allegheny Society of American Foresters
Spring 2005



PA SAF Division Naming Opportunity

By Mark Webb, Consulting Forester, Past ANSAF Chair

I believe everyone reading this magazine is aware that the School of Forestry at Penn State is getting a new building. In fact, it already looks much like a building and plans are underway for when we actually take occupancy! What some of you may not be aware of is the unique opportunity of naming (or sponsoring) an office in that building.

The Pennsylvania Division of SAF has chosen the Goddard Chair Office as its project. Being a part of this effort is *very easy!* The cost for doing this is \$30,000. We are looking for 30 SAF members to pledge \$1,000. Simply pay \$200 per year for five years. Several members have already joined this effort, but there is still a need (and an opportunity) for other members to join us.

The total cost is very affordable. When broken down on a daily basis, it is less than a cup of coffee.

So why be a part of this effort?

First: Opportunities like this one don't come along that often (when was the last time the School got a new building). It will put the name of our organization on permanent display; every person, student, parent, or visitor to the Goddard Chair Office will see the sponsor name, **Pennsylvania Division Society of American Foresters.**

Second: Dr. Goddard has had a great influence on how we practice forestry in Pennsylvania. His leadership has helped to make Penns Woods the envy of many.

Third: Penn State is the only 4-year forestry school in Pennsylvania, and to have the opportunity to have a permanent presence in that building is unique.

Fourth: As an organization we could not afford this, but through the combined efforts of individual donors it is possible. Several other organizations are employing the same strategy for supporting sponsoring projects and we want to be a part of this effort. The building project would not be possible without such private contributions.

Our new building will have a very prominent place on campus. It is intended to be at the new main entrance to the University, sitting at the beginning point for the new arboretum project. Many visitors to campus will pass through our new building. We will reap many benefits from having our organizations name permanently displayed.

Please consider joining in this effort. Each donor will have his or her name listed as supporters of this project. Pledge sheets are available by contacting Mark Webb. The pledge can be a one-time payment of \$1,000 or paid over the 5-year time frame. **For more information or to join in this effort contact:**

Mark Webb
11049 Route 6
Union City, PA 16438
mrkrwebb@earthlink.net or (814) 663-5393

The Allegheny News

Volume 14, No. 1

The Allegheny News is the official publication of the Allegheny Society of American Foresters. Published four times annually. Deadline for articles is December 15, March 15, June 15 and September 15. Subscription rate included in the annual Allegheny Society dues.

The mission of the SAF is to advance the science, technology, education, and practice of professional forestry in America and to use the knowledge and skills of the profession to benefit society.

The Allegheny News

P.O. Box 699 • Dillsburg, PA 17019-0699

Editor Jack Winieski (ansaf@paonline.com)

Layout by Catherine Winieski Carter (catha63@epix.net)

Table of Contents

Chairman's Corner	1-2
The Golden Touch	2
Important Information	2
Mensuration and Estimating Timber Values	2
A Colleague's Goodbye	3
In Memoriam: Robert J. LaBar	3
A Trip to the Ibberson Tree Farm	4
Councilman's Corner	5
ANSAF Education Endowment Fund	6-7
Notes on 2005 Allegheny Winter Meeting	8-10
Allegheny SAF 2004 Treasurer's Report	11
2005 Reginald Forbes Art Show	12
18th Annual Allegheny Student Quiz Bowl	13
Mensuration Card	13
2004 Allegheny Award Recipients	14-16
History of PA Forests Video/DVD	17
Allegheny SAF Winter Meeting Photos	18-19
ANSAF Executive Committee Minutes	20-23
ANSAF General Business Meeting Minutes	23
Field Forester of the Year Nominations Due	24
Winter Meeting Exhibitors and Sponsors	24
2006 SAF National Convention in PA	25
The Paradox of Sustainability	26-27
A Little History	28
MD DNR Forest Service Assumes Management	28
Silviculture News	30
Coming Events	31
Allegheny SAF Committee Chairs	31
Allegheny SAF Chairs, Executive Committee and Division Chairs	32

Cover Photo

Glass slide reproductions like this one are included in the new video/DVD "History of Pennsylvania Forests." Order a copy for your local library or school in the name of yourself and the SAF. See page 17 for order form.



Chairman's Corner

By Kenneth W. Jolly
Allegheny SAF Chair

This issue's column is dedicated to a difficult but very important subject - our Allegheny Budget. As we all know, it takes money to keep our Allegheny Section moving forward to provide the benefits we all enjoy as Section members - approximately \$17,000 to \$18,000 per year. Unfortunately, our annual revenues are not as consistent as our expenses, and typically fluctuate between \$14,500 and \$18,000 per year. In other words, in a good financial year we "break even," but in a bad financial year, we run into a deficit.

Consequently, the Executive Committee usually approves a "tentative budget" at the Winter Business Meeting, with the caveat that depending on how revenue comes in during the year, "cuts" may need to be applied at the Summer Business Meeting. However, at this year's Executive Committee Meeting, based on projections that our 2005 revenues would be insufficient to break even, the Executive Committee elected to cut expenses at the beginning of the year. In addition to the benefit of avoiding a deficit later on in the year, this decision allowed the Executive Committee to make a strategic decision on how to best apply the Budget reductions.

After extensive discussion, it was determined the best alternative to reduce expenses while still maintaining the greatest service to the membership was to eliminate one printed issue of the Allegheny News and substitute an electronic newsletter instead. The electronic newsletter will be a shorter version than the print issue, and will be a text only document - however, members will still receive four newsletters this year. The Summer issue will be the electronic issue. This decision will reduce expenses by slightly over \$2,000 for 2005, and should allow the Allegheny to finish the year "in the black."

Of course, this is only a "stop-gap" solution. We will be facing this same budget situation next year in 2006. Consequently, the suggestion for a potential dues increase was mentioned at the General Business

(Continued on page 2)

(Continued from page 1)

Meeting. The positive side of this suggestion is that for a small increase, we can continue to maintain the level of services currently enjoyed by our membership. On the other hand, we all know that one of the more frequent reasons cited by members who choose not to renew their membership, and also for new members to join, is that the dues level is too high. While I am absolutely convinced the value we receive from being an SAF member far exceeds the dues level, I am also sensitive to the fact that there are members for whom even a small dues increase might be difficult. The Executive Committee has agreed to discuss the matter further at the July 2005 Executive Committee meeting, and I would encourage you to share your thoughts – both pro and con – on this matter with your local Division and/or Chapter Chair, so we can have an informed discussion on how our collective membership views this issue. Your input is very important to your Executive Committee, so please be sure to let your elected leadership know your thoughts on this subject before July – and thanks in advance for your input! ❄

The Golden Touch: 50 Years of SAF Membership

In recognition of fifty years of dedicated service to the Society of American Foresters and to the forestry profession, SAF Golden Members receive a certificate and letter of appreciation from the SAF President, commemorating their career milestone. In appreciation, SAF also waives their membership dues in perpetuity.

The following Allegheny members were recognized from the banquet podium at the 83rd Annual Winter meeting at the Mt. Laurel Resort in White Haven, PA, on February 24, 2005.

Pennsylvania Division

Robert H. Bommer, Jr.

Keith D. Horn

West Virginia Division

R. Joe Johnson

Harry B. Mahoney

Individual recipients not in attendance will be recognized at appropriate gatherings of their respective Divisions or Chapters. ❄

Important Information!

To try and ease our budget situation, the Executive Committee has decided to distribute the summer 2005 issue of the *Allegheny News* via e-mail. This electronic version of the newsletter will contain only text in order to make it easier for any type of internet account to receive it. Currently, we have almost three quarters of our membership's e-mail addresses. We will try to locate e-mail addresses for the remaining quarter of our membership. When the summer issue is released, anyone who does not have an e-mail address in our system will be mailed a paper copy of the same newsletter. If you have an e-mail account that is not listed with SAF and you would like to receive an electronic copy of the summer 2005 issue of the *Allegheny News*, please contact Kim Steiner at 814-865-9351 or Rachel Billingham at 717-783-0385. Please note that this is currently planned for only one of the four issues of the 2005 newsletter. All other issues will be printed and distributed as usual. We will evaluate the success of this measure at our 2006 Winter Meeting. ❄

Mensuration Up-date for Foresters, and Estimating Timber Values for Forest Landowners*

Foresters wishing to brush-up on their Mensuration can download free programs for that purpose. *MensiTutor*, and *Elementary 3P Sampling* are available free at <http://www.geocities.com/harryvwiant/>. Scroll to the citation in the list of publications. At the bottom of the "Stand Up For Forestry" article, you can download a copy of articles written for "The Allegheny News." Also free, is the 55-page book, *How to Estimate the Value of Timber in Your Woodlot* by Harry V. Wiant, Jr., published in 1989. It explains how timber is evaluated using simple non-technical illustrations and is written for forest landowners. It is available at The Pennsylvania Forestry Association web site: <http://pfa.cas.psu.edu/>. Go to "Publications and Products" and scroll toward the bottom.

*Dr. Harry V. Wiant, Jr.

Ibberson Chair, Forest Resources Management

PSU School of Forest Resources

814-865-9602 or hww3@psu.edu

A Colleague's Goodbye

A remembrance by Marian Keegan

Assembling foresters willing to stand at the bedside of a dying colleague is an affirmation of the individual and the spirit that binds us. Our reason for gathering was to honor one who dedicated much of his life to the age-old craft of forestry. For this, **Bob LaBar**, CF, received the Allegheny Society of American Foresters (SAF) 2004 "Bauer Outstanding Service to Forestry" award. Bob LaBar's litany of achievements, dedication to mentoring, and strength of leadership are known to members of SAF, the Association of Consulting Foresters (ACF) and the Pennsylvania Council of Professional Foresters (PCPF). We carried this award to Bob with the highest regards and clearest of intents. And in return, he imparted to each of us a task to carry on.

Foresters attended Bob Bauer's memorial service, and foresters attended Bob LaBar's memorial soon after this presentation. One death was sudden and horrifically unexpected; one slow and agonizingly predictable. In the end, we tended the transport of the earthly wood as carefully as we tended the growth of the stem. We do this as much for each other as we do for ourselves. Standing by one another will carry our leaders and our strengths to our place in the sun. I miss Bob Bauer's enthusiastic call to actions. I shall miss Bob LaBar's guidance. ❧

In Memoriam: Robert J. LaBar

Recently retired consulting forester Bob LaBar, 68, died February 11, 2005. He was educated in forestry and business at Penn State, Yale, and Gannon Universities. Bob worked for the US Forest Service in Oregon, Colorado, Idaho, and Pennsylvania, producing key projects such as Forest Inventory of Fort Knox Military Reservation, Allegheny Reservoir Management Plan, and Allegheny Scenic Railroad Feasibility Study. He worked briefly for the Pennsylvania Bureau of Forestry as a CFM forester. Later, he managed land owned by Hammermill Paper Co. in NY and PA, where he oversaw land sales, purchases and exchanges, leasing of oil, gas, and coal rights, recreation and wildlife.



Robert J. LaBar

For the past decade, Bob operated an environmental consulting firm providing forestry, wetland and sewage enforcement services to landowners and municipalities. His work in the Hemlock Farms Community Association (HFCA), the private community where he lived, put this community and other private communities in the Poconos at the forefront of sustainable development. Bob served on the HFCA Board of Directors, developed a Forest Stewardship Plan and began the long and arduous path to solving problems associated with superabundant deer.

Bob is the 2004 recipient of the Bauer Outstanding Service to Forestry Award, presented by the Allegheny SAF. He joined SAF in 1959 and served in many leadership roles, including Chapter Chairs, Pennsylvania Division Chair, and Allegheny Section Chair. He also was a member and officer of the Association of Consulting Foresters (ACF) and Society of Pennsylvania Archeology. His guidance was sought by the PA Legislative Forestry Task Force. After the SAF Pennsylvania Division formed a Forester Licensing Committee, Bob led the effort as a charter member and President of Pennsylvania Council of Professional Foresters (PCPF), the lobbying organization formed to initiate forester licensing legislation in Pennsylvania.

Bob was active in many churches and community activities, including Boy Scouts and Little League. He was an avid photographer and wood carver. His last carving, a pack mule, ended unfinished. He is survived by his wife Helen, son Rob, daughter Ruth, and several grandchildren. ❧

A Trip to the Ibberson Tree Farm

By Chad Atwood, Penn State SAF Student Chapter Member

At nine a.m. on Sunday October 24, 2004 eight student members and three advisors of the Penn State Student Chapter of the Society of American Foresters met in the Ferguson building parking lot to head south. Their destination was a 450-acre tree farm, one of four tree farms owned by Mr. Joseph Ibberson, a well respected and generous alumnus of Penn State. This particular tree farm is located in Halifax Township, Dauphin County, Pennsylvania was to be no ordinary tree farm. The students, in one of the infamous Penn State "white vanes," focused the conversation mostly on the briskness of the October air.

A little groggy from the night before, the students nonetheless enjoyed testing each other's dendrology skills on passing trees at fifty miles an hour. The banter was thick and changed from classroom topics to tests, summer internships, and extra curricular activities randomly.

Upon arrival at the tree farm the students noticed a sign proudly boasting that this was a "Tree Farm of the Year," and soon would recognize why this special place was given such an award. As we pulled up to a picnic table the focus was on an adjacent bass pond when the reality of just how unique this tree farm really was began to take shape. As flyers were passed around, and Mr. Ibberson was introduced to the group, the history of the farm was discussed. The management plan was presented to the group by Joe Petroski, a graduate student from the Pennsylvania State University, School of Forest Resources. He also proudly displayed his latest



Penn State SAF Student Chapter members eagerly listen to a story by Joe Ibberson as he feeds his enormous bass

trophy buck, which he had harvested while hunting on the tree farm. Then Mr. Ibberson proudly displayed his school of large mouth bass by lofting some food pellets into the pond, bringing the fish to a feeding frenzy.

The tour was a series of car rides and short hikes, showcasing the diversity offered by the tree farm. Mr. Ibberson and Joe acted as excellent tour guides, taking the group to other ponds, a spring, unique trees, and intriguing stands of mixed oak, maple, birch, poplar, and basswood. The tree farm offers numerous exceptional views of the Susquehanna River and its distinctive water gaps. Here the group received a crash course on the topography and geology of the area. The guides also had an extraordinary three-dimensional map of Pennsylvania's topography.

After the tour, the group obligingly accepted the generosity of their hosts, and ate lunch and other provided snacks, while overlooking the farms largest bass pond. The weather was cool and blustery, but the tour was outstanding. Photos were taken and there was one last round of Q&A before the group had to depart for State College. With brains and stomachs full, more forestry related conversation made the ride home seem short. It was a very inspiring trip, and special thanks goes out to our host, Mr. Ibberson, and Joe Petroski.



Examining a 3D topographic map of the area



Councilman's Corner

By Mike Lester, SAF District VII Representative

I wanted to take this opportunity to remind everyone that the SAF Leadership Academy is scheduled for June 11-14, 2005. It will once again be held at the Lieds Arbor Day Center in Nebraska City, Nebraska. The Lieds Center, with its large timbers in the foyer, is one of the most impressive meeting centers that I've been to, and a perfect setting for the Academy.

Should you attend? YES! Our leaders are not just those who happen to be the current Chair or Chair-elect. Chapter chairs, members of the Executive Committee, and also those of us willing to lead new efforts. We also need to send our younger members who show promise, but need to acquire leadership skills. You don't have to think about it for very long, before a lot of names in the Allegheny come to mind.

One of the striking impressions I have from last year's Academy was more than the quality of the attendees, but also the age range. We had leaders represented in every age group from the 20s to the 60s. Another interesting aspect of last year's Academy was the number of folks that employers had sent to help key employees grow into better, more effective leaders.

The key to a successful Leadership Academy is attendance. I want to challenge the Allegheny to find these leaders. At a minimum, each Division and the Allegheny should each send at least one member to the Academy. I realize that money is tight for all of us, so we are going to have to do our best to convince our employers to help. It's an investment that will pay them back many times over. Where at all possible, the Divisions and ASAF should help defray the costs where attendees can't get total support from their employers. The Allegheny was well represented last year. Let's make this year equally successful.

More information about the Leadership Academy, including the agenda and registration form, can be found at the SAF website's homepage, www.safnet.org. Don't miss it.

My last column dealt with the Volunteer Organizational Structure (VOS) Task Force report. At our last Council meeting, we spent an entire day discussing the report and its implications. Several key messages emerged.

The first conclusion was that more time was needed for the membership to evaluate and provide feedback for the report. Council had originally said that feedback would be taken until June 1. That date has been revised to November 9, 2005. That gives the House of Society Delegates (HSD) time to fully discuss the report at their annual meeting in October at the SAF National Convention in Ft. Worth.

There was a fair amount of concern expressed over too much energy being focused on the recommendations detailed in the report as opposed to the significant problems that SAF is facing that were chronicled in the Forward of the report (read this, if you read nothing else). The issues articulated in the Forward will represent the real challenges that we will need to address if we are going to ensure the future of SAF and the forestry profession.

Finally, the message regarding the focus of the report was clearly articulated. All of the suggested organizational changes revolve around three key needs or foci; Members, Students, and Science. If you look at the Recommendations, you will see elements of those three entities in all.

It is important to remember that the VOS Task Force Report is just that, a report. Having said that, it is an impressive document, and the Task Force members are some of the most eminent members of SAF. After collecting feedback, Council may choose to accept all, some, or none of the recommendations. It may choose to alter some recommendations. While the Report may not have much of an impact at the Chapter or even Division level, it could change the way the Society is governed. It may also strengthen the focus of SAF. You can find the report on the website by following this path, About SAF>SAF Structure> Volunteer Organizational Structure (VOS) Task Force Report.

Carpe Diem.

ANSAF Endowment Fund at \$31,485

By Ron Sheay, Endowment Fund Coordinator

Since the last newsletter, 21 members have contributed \$2,035 to bring the Education Endowment Fund total to \$31,485. The non ad hoc group was formed two years ago in an attempt to increase the endowment fund by \$40,000. Those two years are up and the group will be dissolved but the fund will remain open. All 171 contributors are listed by categories in this article. If your name is missing, you may rectify that by sending a contribution to Ron Sheay, 12 Glenwood Lane, Stockton, NJ 08559, payable to ANSAF Endowment. We thank all the following members that have made a contribution since the *Winter Allegheny News*:

John Benton *	NJ	Steve Mauer *	NJ
Bill Brash	NJ	Charlie Newlon *	PA
Ray Cywinski	NJ	David O'Barto *	PA
Heather Gracie-Petty *	NJ	John Peters	PA
Edd Hogan *	NJ	Bob Rumpf **	PA
Keith Horn *	PA	Susan Stout *	PA
Al Knox *	PA	Mark Vodak *	NJ
Gary Lovallo *	NJ	Stan Walton *	PA
Tunis Lyon *	MD	Herman Warth *	Germany
Sam Mace *	DE	Dick West *	NJ
		Jim Wiles *	NJ

Sub total	\$ 2,035.00
Previous Total	<u>29,450.00</u> (Winter Newsletter)
Grand Total	\$ 31,485.00

* Indicates a second donation has been given

** Indicates a third donation has been given

All contributors to the Allegheny SAF Education Endowment Fund since its inception are listed by categories:

Contributions of \$10.00 - \$99.00

Alvin Allison	Glenn Gladders	Greg McLaughlin
Alfred Appel	Calvin Clattfelder	Charles Merroth
David Babyak	Curt Gottschalk	John Moser
Charles Beach	Duke Grimes	Niederer Firewood & Tree Service
Richard Bentz	Joe Haug	Ernest Ogden
Andrew Blazewicz, Jr.	Paul Higby	James Parsons
William Brash	Terry Hoffman	Penn Green Log, Inc.
Bruce Brenneman	Tim Holtz	Jack Perdue
Patrick Brose	George Howard	Blaine Puller
Charles Brown	Russell Hutnik	Robert Radspinner
Tom Bullock	Craig Kane	Anthony Santoli
Richard Cary	Boyer Kantz	Schaier Bros. Sawmill
Scott Cary	Dan Kincaid	Herb Seidel
Lloyd Casey	James Klunk	Jack Shuart
Robert Cockroft	Allan Knox	Clay Smith
Raymond Cywinski	George Koeck	Daniel Snyder
Dave Edelman	Melvin Lewis	James Snyder
Paul Eriksson	Richard Lewis	David Steward
Mary Ann Fajvan	Paul Lilja	Ben Stout
Lynn Frank	Maier Lumber Company	Raymond Strang
Dennis Galway	Steve Maurer	William Vanidestine
George Gilmore	Melanie McDermott	Howard Wurzbacher

Contributions of \$100.00 - \$249.00

Acmi Co., Inc.
Les Alpaugh
Jim Barresi
Blue River Lumber Co., Inc.
Robert Bond
Eric Carlson
Tracy Cate
Terry Clark
Helene Cleveland
Mark & Anne Conley Pitchell
Warren Doolittle
Paul Felton
Jim Finley
Henry Gerhold
Steve Goodman
Gracie & Harrigan
Christina Harrigan
Ralph Heilig
Frank A. Hennion Memorial
Frank Hennion
Edd Hogan
Ken Jolly
Tim Kaden
Bill Kidd, Jr.

Jeffrey Kochel
Steve Koehn
Tom Koeppel
Howard Kriebel
Land Dimensions Engineering
Austin Lentz
Long Life Treated Wood, Inc.
Jim Mallow
Dave Marquis
Dave McGill
Michael McKain
V.U. Megnin
Rex Melton
Raymond Miller
Dick Mires
Orange Mulhollen
Jim Nelson
Charles Newlon
New Jersey Tree Farm
David O'Barto
Roxane Palone
Arlyn Perkey
John Peters
Everette Rast

Steve Resh
Walter Rossman
William Scherer
Roger Sherman
Tim Slavin
Peter Steger
Stella Contracting, Inc.
Cecile Stelter
Susan Stout
Doug Tavella
Doug Toothman
Dave Trimpey
Valley Forge Chapter - SAF
Mark Vodak
James Wadsworth
Syd Walker
Stanley Walton
Hermann Warth
Dave White
Olin White, Jr.
Harry Wiant
Jim Wiles
Robert Williams

Contributions of \$250.00 - \$499.00

Judson Bennett
John Benton
Bill Corlett
Thomas Delong
Dwight Fielder, Jr.

Conrad Franz
Heather Gracie-Petty
Gordon Manuel
Gary Lovallo

Tunis Lyon
Samuel Mace
John Perry
Austin Short

Contributions of \$500.00 +

Gordon Bamford
Errett Conway
Alex Day
Kenney Funderburke
Keith Horn
Joseph Ibberson
Ken Kane

Edward Kocjancic
Maryland/Delaware Division - SAF
New Jersey Division - SAF
Northern Hardwoods Chapter - SAF
Pennsylvania Division - SAF
George Pierson
Riephoff Sawmill, Inc.

Robert Rumpf
Ronald Sheay
Roy Siefert
Mark Webb
Richard West
Jack Winieski
Wilbur Wolf

The Non Ad Hoc Group of Jim Nelson, Wilbur Wolf, Charlie Newlon, Jack Winieski, Alex Day, Mark Webb, Susan Stout, Roy Siefert, Ron Sheay, George Pierson, Tim Kaden, Steve Resh, Roger Sherman, Dave McGill and Ken Kane heartily thank all Allegheny SAF members for their fantastic support of the endowment fund effort. Now let's put the investment income to good use through some educational programs. ❄

Meeting/Workshop Notice

The 2005 Penn State Eastern Hardwood Regeneration Institute will be presenting the workshop *Oak Regeneration* on May 17, 2005 at the Ag Progress Days site. This workshop will feature a field session in the morning to introduce data collection methods and to collect data to be reviewed during the indoor session in the afternoon. For more information, please contact Mike Powell at 814-863-1113, or email him at mjp175@psu.edu ❄

Notes on the 2005 Annual Winter Meeting

By Richard Cary, Chair, SAF Pinchot Chapter

The 2005 annual meeting, hosted by the Pinchot Chapter of the PA Division, was held in the Poconos at the Mountain Laurel Resort & Spa near White Haven, PA. In addition to Dick Cary, Chairman of the Pinchot Chapter, the conference planning committee that worked hard over the year to put this together included: Denise Cooke-Bauer, Mark Diebler, Brad Elison, Marian Keegan, Al Knox, Bob LaBar, Nick Lylo, and Don Oaks. Others who helped with various functions at the conference were: Todd Hagenbuch, Bob Hobbes, Charlie Newlon, Will Price, Robin Wildermuth, and Jim Winch.

Opening remarks given by Pennsylvania State Senator Ralph Musto and keynote speaker Dr. James R. Grace, Pennsylvania State Forester, the insights of SAF National Executive Vice President Michael Goergen and National Director of Meetings and Conventions, Madelaine Morgan, the premiere showing of the Jim Nelson video, "History of Pennsylvania Forests," the Awards Banquet and the stimulating banquet presentation of Penn State Mont Alto's Dr. James

Hamilton, all wrapped around a core of the professional program theme, "Sustaining Biodiversity, Open Space and Forestry."

The object of the presentations was to explore and illustrate how foresters and forestry can support and contribute to sustaining biodiversity and preservation of forestlands. Our profession is not all about timber. We should assure that timber production and silviculture contributes to sustaining biodiversity and open space values. To this end, foresters and other land management speakers were asked to address the program theme with background and innovative practice presentations for information and discussion among the 160 professionals and forestry students in attendance.

Following are abstracts from the presentations that were ultimately selected to represent the theme of the program.



Richard Cary, SAF Pinchot Chair

SUSTAINING BIODIVERSITY

Biodiversity: What We Don't Know Can Hurt Us or Why We Need More Inventory and Monitoring of Pennsylvania's Biological Resources. Ann F. Rhoads, PhD, Senior Botanist at the Morris Arboretum of the University of Pennsylvania

Abstract: Protecting and conserving the natural biological resources of Pennsylvania for future generations should be a goal of all of us. The more we know about those resources, the more effective we can be. Species diversity of vascular plants (ferns and fern allies, conifers, and flowering plants) and vertebrate animals (mammals, birds, reptiles, amphibians, and fishes) is fairly well documented. However, basic inventory of most invertebrate animals, non-vascular plants, fungi, and microorganisms is fragmentary at best, despite the fact that many of these organisms carry out essential ecosystem services. We don't understand nearly enough about the dynamics of year-to-year changes in population levels of many of the species that make up our biological diversity. And we have even less information available regarding the genetic diversity within species. Monitoring needs include measures of ecosystem function and health. Despite the gaps in our knowledge, we need to proceed as best we can with programs to conserve biological diversity, adjusting techniques as new information becomes available through a system of adaptive resource management. Too much will be lost if we wait.

The Pennsylvania Biodiversity Conservation Plan. Sue Thompson, President, The Pennsylvania Biodiversity Partnership

Abstract: The Pennsylvania Biodiversity Partnership (PBP) is a public-private partnership dedicated to increasing awareness of the importance of biodiversity conservation in Pennsylvania. Organized in 2000, PBP brings together organizations and individuals with diverse interests and backgrounds. Working with its partners, PBP is developing a biodiversity conservation plan with a target deadline of late 2005. The plan builds on *Biodiversity in Pennsylvania: Snapshot 2002* produced by PBP. Since 2003, PBP has gathered information via public comment forms, focus groups, and interviews to determine the most pressing biodiversity concerns in Pennsylvania and to identify consensus items to be included. General topics to be incorporated include science-based issues, datasharing, education, stewardship, public policy, and funding.

Monitoring Pennsylvania's Forests via the USFS Inventory Process. William McWilliams, Inventory Coordinator, FIA, USDA Forest Service

Abstract: In 2000, the USDA Forest Service, Northeastern Research Station, Forest Inventory and Analysis (FIA) program implemented a new system for inventory and monitoring Pennsylvania's forests. Salient features of the new inventory process include a nearly threefold increase in timeliness and an expanded set of measurements. Basically, the inventory is conducted over a five-year period by measuring one-fifth of the State's sample plots in any given year. The first four years of data have been collected and compiled. The results shed light on current conditions and trends in a host of indicators. The overall forestland base is relatively stable in terms of total acreage; however, pressures of parcelization and fragmentation threaten forests in urban and urbanizing areas of the Commonwealth. A large block of forestland of similar age that is gradually reaching financial maturity characterizes the State. Although overall inventory volume continues to increase, the rate of increase has slowed based on the latest findings. Concurrent with the expansion of the inventory has been a general lack of adequate advance tree-seedling regeneration and threats from natural and introduced invader species, such as rhizomous fern, striped maple, grasses, and others. These findings are discussed in the context of sustaining biodiversity, open space, and forestry.

SUSTAINING OPEN SPACE

Overview of Highlands Case Study. Ed Boyer, ASLA, Highlands Conservation & Stewardship coordinator, USDA Forest Service

Abstract: The Highland terrain is a landscape of rugged mountains and ridges whose elevations are seldom greater than 2000 feet above sea level. The Highlands of Connecticut, New York, New Jersey, and Pennsylvania are bordered to the south and the east by the more subdued topography of the Piedmont Province, and by the broad corridor that joins the east-coast cities in one continuous band of urban development. To the north and the west of the Highlands lies the Great Valley, a geological feature stretching from Connecticut to Virginia, and variously named according to which river crosses it. The Highlands is a region of forests, lakes and headwater streams; it provides water for millions of people in the metropolitan area. It makes a broad, green edge for the Boston-to-Washington urban corridor. Its forests cool and cleanse the air. The challenges are conserving the forests and the important environmental services they provide. Development is pressing hard upon the Highlands. Given knowledge, tools, and the spirit of cooperation, the Highlands' communities can conserve the natural systems, insure the purity of headwaters streams, accommodate recreation and protect their farming and forestry culture by responding to change and guiding it.

The Challenge of Conserving Eastern Forests. Tom Gilbert, Director of Eastern Forest Conservation, Wilderness Society

Abstract: Eighty-four percent of eastern forests are privately owned and many of these forestlands are increasingly threatened by poorly planned and sprawling development. Every day, approximately 50 acres of forest are converted to development in the eastern forests region stretching from Alabama to Maine. If we are to protect the many natural and economic benefits that forests in the East provide to people and communities, then we must conserve important private forestlands. A coordinated effort is needed between the land conservation and forestry communities to build strong public and political support to increase federal, state and private funds available to conserve private forestlands in the East through public acquisition, purchase of development rights, and other means. Conserving these lands is essential to ensure clean

ONE STOP SHOP.

- seedlings
- transplants
- liners
- container
- b & b

75 years of growing.

Over 150 Varieties available.

Pine: Austrian, Balkan, Japanese Black, Pinyon, Mugho, Ponderosa, Red, White, Virginia
Spruce: Black Hills, Blue, Engelman, Norway, Serbian, White
Fir: Balsam, Canaan, Concolor, Douglas, Fraser
Hemlock: Canadian
Birch: European, Japanese, Gray
Dogwoods: Chinese, Gray, Silky, Siberian, White
Locust: Black, Bristly, Honey
Maples: Norway, Red, Silver, Sugar
Oaks: Black, Bur, English, Pin, Scarlet, Sawtooth, Red, White, Swamp, Willow

Button Bush, Catalpa, Cherry, Red Cedar, Ginkgo, Poplar, Sumac, Serviceberry, Viburnums

1-800-643-8319 Dept. 85-D

Indiana, PA
Phone 800/643-8319
Fax: 724/465-9893
wholesale@musserforests.com

MUSSER forests inc www.musserforests.com

Key Code: 85F02

A complete list is available upon request.



(Continued from page 9)

air and water, a sustainable supply of forest products, habitat for diverse species of wildlife and opportunities to recreate in and enjoy forests in this densely populated region.

New Jersey SAF Position Statement on Land Use Planning and Stewardship. Dennis Galloway, Chair of New Jersey Division SAF

Abstract: In an attempt to balance rural development and in efforts to preserve green space, municipalities have adopted and/or introduced tree-harvesting ordinances. Although well meaning, many tend to be unrealistically restrictive and often discourage proper forest management. The New Jersey Division of SAF believes that qualified forestry professionals with broad education, training, and experience in natural resource management provide an invaluable resource in helping communities develop land use policy and ordinances that are specific to tree cutting and green space management.

SUSTAINING FORESTRY

Recent Progress in Understanding Oak Regeneration. Kim Steiner, Professor, PSU School of Forestry

Abstract: Results are presented from recent research based on Penn State's Regeneration Dataset and archival Pennsylvania Bureau of Forestry data. Among the topics covered: oak regeneration success in the short term (4-7 years) and long term (20+ years) following harvest in mixed-oak stands; contribution of seedlings vs. stump sprouts to oak regeneration; methods of quantifying regeneration stocking, and newly developed guidelines for evaluating the adequacy of oak regeneration potential and developing prescriptions for achieving regeneration success.

Effects of Clearcutting and Partial Harvesting on Tree Species Diversity. Mary Ann Fajvan and Thomas Schuler, USDA Forest Service, Northeastern Research Station

Abstract: Both clearcutting and partial cutting practices resulted in decreased tree species diversity in Appalachian hardwood stands on the Fernow Experimental Forest in Parsons, WV. From 2-26 years after clearcutting the importance value of oaks, hickories, American beech, sugar maple and black birch decreased while the importance of yellow poplar increased. The effects of single-tree selection, diameter-limit harvesting and patch cutting on diversity and productivity were documented after a half-century of management (1950 - 2000). Single-tree selection resulted in the greatest decline in diversity, but no more than unmanaged reference areas. The best quality sites were also the most likely to exhibit trends in declining diversity. The increasing dominance of shade tolerant species on the best quality sites has not yet resulted in a trend of declining net periodic annual increment.

Old Growth Forest Restoration: Should We Muck with it? Dylan Jenkins, Director, Forest Conservation Program, The Nature Conservancy

Abstract: Pennsylvania is establishing a half-million-acre old growth forest system within its 2.1 million acres of state forest. If successful, this system will contribute to the restoration of landscape and stand-level ecological functions associated with old growth forests that have virtually disappeared from eastern ecosystems. However, the proposed old growth forests must be resurrected from fragmented and structurally homogeneous second-growth forests that are subject to anthropogenic disturbances. In the context of these disturbances, application of silvicultural practices will be necessary to protect, restore, and accelerate the accumulation of old growth attributes in Pennsylvania's forests. ❧

Casey's Forestry Concepts

"A New Kind of Consulting"

**Income Tax Reduction • Conservation Education
Restructuring Plans to Reduce Tax • Ordinance Development**

Lloyd R. Casey
1263 Palomino Drive Phone: 610-436-9424
West Chester, PA 19380 email: lrcasey@comcast.net



BETTER FOREST CONSULTING SERVICES

EDGAR H. PALPANT, CF
Consulting Forester

*"If a better system is thine, impart it;
if not, make use of mine." Horace (965-8BC)*

Operations:
Peachy Road
Mc Alevys Fort, PA



R.D. #1, Box 709
Petersburg, PA 16669
Phone: (814) 667-5088
Fax: (814) 667-5089
E-mail: EHPAL@CS.COM

BETTER TREES - THROUGH BETTER SEED - THROUGH RESEARCH
Specializing in Christmas Tree Management

Allegheny Society of American Foresters 2004 Treasurer's Report

BEGINNING BALANCES (on January 1, 2004)

Checking Account	\$12,312.35
Endowment Savings	\$33,216.90 ¹
Endowment CD	\$ 0.00

CHECKING ACCOUNT

CHECKING ACCOUNT INCOME:

2004 Allegheny Dues	\$ 8,299.50 ²
2005 Allegheny Dues	3,278.75
2004 Div/Chp dues (pass through)	3,074.25
2005 Div/Chp dues (pass through)	1,246.50
2004 Winter Meeting-MD/DE Div.	2,000.00
2004 Summer Meeting-WV Div	1,000.00
Tax Issues Workshop (pass through to PSU) ³	3,024.00
Other Contributions:	
Tax Issues Workshop Profit ³	\$ 1,716.00
MeadWestvaco donation (for Allegheny News)	500.00
Bob LaBar (Reginald Forbes Art Contest)	105.00
Dennis Galway (Reginald Forbes Art Contest)	105.00
James O. Nichols	100.00
Checking Account Interest	\$ 2.15
Total Checking Account Income:	\$ 24,451.15

CHECKING ACCOUNT EXPENSES:

2004 Div/Chp dues (pass through)	\$ 3,019.50
2005 Div/Chp dues (pass through)	1,246.50
HSD Assessment	527.40
Allegheny News (4 issues/bulk mail imprint)	8,090.85
Executive Director Stipend/Expenses	6,660.00
Awards	158.87
Reginald Forbes Art Awards	310.00 ⁴
Student Travel	800.00
Seed Money to Pinchot Chapter for Winter Mtng	750.00
Payment to PSU for Tax Issues Workshop (pass through) ³	3,024.00
Total Checking Account Expenses:	\$ 24,587.12

CHECKING ACCOUNT INCOME LESS EXPENSES:

\$ (135.97)

CHECKING ACCOUNT BALANCE AS OF 12/31/2004:

\$ 12,176.38

ENDOWMENT SAVINGS ACCOUNT

ENDOWMENT SAVINGS ACCOUNT ACTIVITY:

Beginning Balance	\$ 33,216.90 ¹
Begin new CD	(29,115.00) ⁵
Endowment Fund Contributions	10,255.00 ⁶
Interest	35.02
Leadership Academy Fees	(550.00)

ENDOWMENT SAVINGS BALANCE AS OF 12/31/04:

\$ 13,841.92⁷

ENDOWMENT CD

ENDOWMENT CD ACTIVITY:

Beginning Balance	\$ 0.00
Endowment CD opened	29,115.00 ⁵
Interest	109.08 ⁸

ENDOWMENT CD BALANCE AS OF 12/31/04:

\$ 29,224.08

Respectfully Submitted by:
Rachel R. Billingham
Allegheny SAF Secretary/Treasurer

Audited by:
Ronald J. Sheay

¹ This amount consists of \$4,476.90 of endowment savings funds, and \$28,740.00 of endowment CD funds.

² This amount consists of dues that were collected in the 2004 calendar year. The total amount collected for the dues year 2004 was \$12,530.50.

³ Through the efforts of Ken Kane, this workshop was set up so that any revenue would go to the Allegheny SAF.

⁴ Reginald Forbes is a non-budgeted item. This fund began with an \$80 surplus and ended with a \$20 deficit, which will be rectified with 2005 donations.

⁵ This amount consists of the 2003 end-of-year balance of \$28,740 plus \$375 of contributions received in early 2004 (these funds were deposited into the new CD when it was opened).

⁶ This amount represents all contributions received in 2004, including the \$375 that was already transferred into the CD early in the year, as noted in footnote #5. Therefore, \$9,880 will be transferred to the CD in mid-February 2005.

⁷ Note that \$3,961.92 of these funds are liquid and \$9,880 will be transferred to the endowment CD in February 2005.

⁸ This interest (as well as the interest accrued as of 2/13/2005) will be transferred to the Endowment Savings Account - this will add to the amount that will be available as liquid funds.

2005 Allegheny SAF Reginald Forbes Art Show

By Charlie Newlon, Artistic Director

In 2005, for the first time, we had a category for kids 11 years of age and under. Winners in this category were from Pennsylvania and West Virginia. Evan Lynn, Kassie Hollabaugh, Martha Carter and Kyle Carter were the Kids Category winners. Their artwork media ranged from the use of natural objects, clay figures to computer art.

Eleven SAF members and their family members from New Jersey, West Virginia, and Pennsylvania Divisions entered twenty art pieces in the Reginald Forbes Art Show. Entries were judged by ballot by meeting registrants. Prizes awarded were \$25 for first place, \$15 for second place, and \$10 for third place (when applicable).

For the 4th year, the Art Show was entirely financed by donations from members. In memory of Bob LaBar, who passed away in February and his long-term support of the Forbes Art Show, the Bob LaBar Family contributed \$100 toward the cash prizes given to the winners. Dennis Galway matched Bob's family donation by contributing \$150. Rachael Billingham, Marilyn Hennion, and Paul Higby donated their 2005 prizes for a total of \$75 back to the fund to seed the Society's Art Show fund. Charlie Newlon donated \$113 and the ballots, entry forms, and certificates. In 2004 the Art Show fund went \$20 in the hole. As a result of this year's generous donations the Show ended with a surplus of \$68. The winners are listed below.

Kids Category

Open Class

Place	Subject	Artist
1 st Place	"Pioneer Scene" - Native Materials	Evan Fajvan Lynn
2 nd Place	"Biodiversity Matters" - Clay	Kassie Hollabaugh

Flat Art

Place	Subject	Artist
1 st Place	"Aerial Saucers" - Computer Art	Martha Grace Carter
2 nd Place	"Castles" - Computer Art	Kyle Max Carter

Professional Category

Flat Art

Place	Subject	Artist
1 st Place	"Thistle Flower" - Note Cards	Suzanne Matlock
2 nd Place	"Tudor Home" - Note Cards	Suzanne Matlock

Amateur Category

Three Dimensional Art

Place	Subject	Artist
1 st Place	"Jewell Mill" - Carving	Paul Higby
2 nd Place	"Braided Rug" Black n Brown	Dennis Miller
3 rd Place	"Metamorphosis"	Rachael Billingham
HM	"Tree of Life" - Cross Stitch	Amy Cassell

Flat Art - Painting, Sketch and other

Place	Subject	Artist
1 st Place	"Sign of the Times" - Watercolor	Marilyn Hennion
2 nd Place	"Old Reliable" - Watercolor	Marilyn Hennion

Flat Art - Photography

Place	Subject	Artist
1 st Place	"Lakota Wolf Preserve"	Lorie Tavella
2 nd Place	"First Snow"	Catherine Carter
3 rd Place	"Mount Hood-3 Photos"	Paul Higby
HM	"Barn Swallow Chicks"	Walter Rossman

Sculpture

Place	Subject	Artist
1 st Place	"4 Powder Horns"	Joe Harding
2 nd Place	"Q. rubra leaf" - Stained Glass"	Jennifer S. Keefer
3 rd Place	"Carved leaves on Jake Staff"	Ty Ryen
HM	"Beaded bottle"	Rachael Billingham



Charlie Newlon announces the 2005 Reginald Forbes Art Show Winners

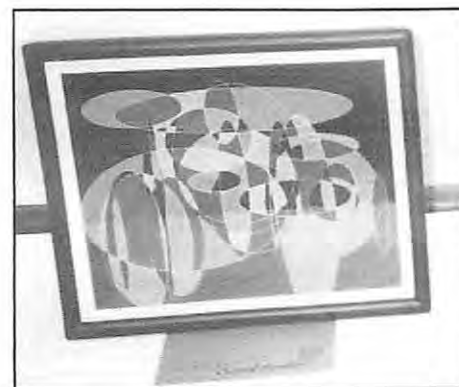

The 18th Allegheny SAF Student Quiz Bowl

By Steven Resh, Chair, ANSAF Student Quiz Bowl Committee

Students from four technician schools and one university took center stage to participate in the 18th Student Quiz Bowl at the 83rd Annual Winter Meeting of the Allegheny SAF. The gathering, hosted by the Pinchot Chapter, took place at the Mountain Laurel Resort & Spa in White Haven PA. Most of the 160 registered foresters stayed in the meeting hall to witness one of the most exciting contests in recent memory.

Steve Resh, quiz bowl coordinator, commented to the audience before the first round about how important the event has become to the success of the winter meeting and how much student participation has grown since he first proposed the contest more than 18 years ago. This was the first quiz bowl in which all four recognized forest technician schools from the Allegheny SAF have participated. Resh challenged the five schools at this year's meeting, as well as the absent WVU and Rutgers teams, to make next year's contest in Pennsylvania the biggest quiz bowl ever!

The first 20-minute round pitted Allegany College of Maryland against the Pennsylvania College of Technology in an exciting contest



Left to right: Harry Wiant, student winners Bob Lindemuth, Amanda Subjin and Carson Engelskirger, Advisor Mike Powell and Quiz Bowl Chair Steve Resh

that saw Penn College advance to the tech school finals. Their competition would be determined by the contest held between Penn State Mont Alto and the new team on the block from Glenville State College of Glenville, West Virginia. Even though the Glenville students represented their school very well, they eventually tasted defeat because of the quick minds and responses of the Mont Alto team.

Mont Alto was able to claim the technician school crown by defeating Penn College in the third round to set up a very exciting final between Penn State (Mont Alto) and Penn State (University).

The Penn State University team comprised of students **Bob Lindemuth, Amanda Subjin, and Carson Engelskirger** were able to defeat their Mont Alto counterparts by five points in an exciting contest that saw three lead changes and two ties.

Congratulations to all participants for giving us a contest that was both exciting and humbling to all those in attendance. The students would like to thank the Pinchot Chapter members for providing the award plaque and to thank judges Jack Winieski, Tim Kaden and Paul Erickson for a great job. ❄

Mensuration Card

This guide by Harry V. Wiant, Jr. (PSU) and John R. Brooks (WVU), can be glued to the back of a business card, and is useful when quick, rough estimates of timber volume are needed. Calibrate your thumb to serve as a BAF=10 instrument, the place where it covers a foot-wide target when your eye is 33 feet away, and you are ready to go! ❄

MENSURATION CARD

D=dbh, L=16-ft logs, H=tot ht ft, BA=basal area/ac
bf/tree=f*D²*L (f: Int =0.366, Scrib =0.333, Doyle=0.279)
bf/ac=f*BAF*L (f: Int =67, Scrib =61, Doyle=51))
ft³/tree=0.0023*D²*H
ft³/ac=0.42*BAF*H
cords/tree= 0.00025*D²*H
cords/ac=0.0046*BAF*H
stand hwd: ft³/ac = 0.42*BA*avgH
stand conifer: ft³/ac= 0.46*BA*avgH

2005 Allegheny SAF Award Recipients

By Howard Wurzbacher (Allegheny Awards Committee Chair) and Marian Keegan

The Bob Bauer Outstanding Service to Forestry Award recognizes outstanding professional conduct and achievements in forestry, the promotion of forest conservation and service to society over the time span of one's professional career.

Robert J. LaBar, CF, was named the recipient of the 2004 Bob Bauer Outstanding Service to Forestry Award given by the Allegheny SAF. Bob was gravely ill at the time of his nomination and selection, and he was presented with the Award by friends and members of the Pinchot Chapter and Allegheny SAF in the hospital prior to his death before the Allegheny SAF Winter Meeting in White Haven, PA.

As Awards Committee Chair I would like to thank the members of the selection committee who showed quick and decisive action to expedite voting and preparation of the award, and those individuals who traveled to the hospital to make the award presentation to Bob and his family.

Bob Labar was a leader in professional achievement from his student days at Penn State into his retirement years. As a student at Penn State, he co-founded the annual Penn State/West Virginia field days. Bob's career path began with the US Forest Service in Oregon, Colorado, Idaho, and Pennsylvania. Some key projects with the US Forest Service included Forest Inventory of the Fort Knox Military Reservation, the Allegheny Reservoir Management Plan and the Allegheny Scenic Railroad Feasibility Study. He worked briefly for the Pennsylvania Bureau of Forestry as a CFM forester. Later, he managed 185,000 acres in PA and NY owned by Hammermill Paper Co., where he oversaw land sales, purchases and exchanges, leasing of oil, gas, and coal rights, recreation and wildlife. Some key projects with Hammermill include Forest Wildlife Management Guidelines; Recreation, Real Estate Inventory; Resource Management Plan; and Undevelopable Lot Studies in Fawn Lake Forest. A key project while working briefly with George Kemp & Associates in Warren PA was the Camp Mission Meadows Development Plan.

Bob joined SAF in 1959. He served as Chapter Chair of the Northern Hardwoods, Plateau and Pinchot Chapters, Pennsylvania Division, and Secretary/Treasurer and Chair of the Allegheny SAF Society. He was part of the Planning Teams for four Winter Meetings in Erie PA, Dover DE, Scranton PA, Matamoras PA, and served on the team planning the 2005 Winter Meeting in White Haven PA. In 1983, he wrote the "Guidelines



Helen LaBar (center) and son Rob (right center) accept the 2004 Bauer Outstanding Service to Forestry Award in honor of husband and father Bob LaBar. Left to right: Mike Lester, Ken Jolly, Helen, Rob, Howard Wurzbacher

and Suggestions for Annual Society Meetings" for the Allegheny SAF, which is still being used to help host units in insuring technical and financially successful meetings. He was a co-founder of the SAF Deer Management Committee, spearheading much needed changes at the PA Game Commission to address forest regeneration. He was a charter member of the PA Council of Professional Foresters, served as president of the Board of Directors of that organization and also served as President of the PA Chapter of the Association of Consulting Foresters.

For many years, Bob was involved in the Society of Pennsylvania Archaeology, which included excavations of Indian forts on the Allegheny National Forest and published in *The Pennsylvania Archaeologist*. He received the "Archie Award" for being an outstanding amateur archaeologist. His knowledge of forest soils led to wetland and sewage enforcement services to many municipalities experiencing the growing pains of rapid development. He was an avid photographer and woodcarver, and had been generously supportive of the Annual Allegheny SAF Reginald Forbes art contest.

A main focus of Bob's life was his family and his faith, and he and his wife Helen were active in churches in the many communities in which they lived.

Bob LaBar's conduct throughout his career defined leadership and ethical conduct in the Forestry profession, and is absolutely deserving of the peer selected 2004 Robert W. Bauer Outstanding Service to Forestry Award.

The Forester of the Year Award recognizes individual specific professional achievements in a current time span, in this case 2004.

Robert Williams, CF, of the New Jersey SAF recently received the 2004 Allegheny SAF Forester of the Year award at the Allegheny SAF Winter Meeting in White Haven, PA on February 24, 2005. Candidates for consideration for the award are nominated by Chapter and Division Chairs, and are selected by members of the Awards Committee who represent each State Division within the Allegheny and serve individually and anonymously as part of the selection Committee.



Robert Williams (left) receives his award from Awards Chair Howard Wurzbacher

Bob is a consulting forester from southern New Jersey, and has implemented forestry practices on varying ownerships within an intense regulatory climate within the Pine Barrens and other areas in southern New Jersey and Northern Maryland. In 2004, Bob presented a program on woodlot management at the New Jersey Agricultural Convention; he was elected to the Board of Directors of the New Jersey Forestry Association, and was

also appointed to the Pinelands National Reserve Forestry Advisory Committee. In 2004, Bob worked to prepare and present a proposal to the New Jersey Department of Environmental Protection to help initiate the 80,000 acre West Plains Fireshed Plan. He has worked in conjunction with conservation groups such as the Ruffed Grouse Society, Quail Unlimited, Ducks Unlimited and Trout Unlimited on numerous habitat improvement projects. Bob also authored or contributed to articles and editorials

published in the New Jersey Tree Farmer magazine, the Pinelands Restoration Alliance newsletter, and the Ecological Restoration Journal.

These activities and accomplishments demonstrate Bob's active and vocal participation within the forestry and natural resources community, and make him a deserving award recipient. ❄

The SAF Presidential Field Forester of the Year Award recognizes foresters who have dedicated their professional careers to the application of forestry on the ground using sound, scientific methods and adaptive management strategies. It is presented at the District level to a member who has displayed uncommon talent, skill, and innovative methods to achieve a record of excellence in the application of forest management.

Stephen E. Jaquith, CF, ACF, is a Consulting Forester and member of the Allegheny SAF, and is one among the ten foresters from ten SAF National voting districts honored with the 2004 Presidential Field Forester Award. He was chosen for the honor from SAF District VII, which includes the Allegheny and the National Capital Societies.



Award recipient Stephen Jaquith (left) with Mike Lester

Jaquith was recognized at the Joint meeting and convention of the Canadian Institute of Forestry and the Society of American Foresters, in October in Edmonton, Alberta, Canada. He was also recognized and presented the plaque at the recent Awards Banquet of the Allegheny Winter Meeting in White Haven, PA.

Stephen, a consulting forester for the past 15 years, provides forest management services to owners of private, corporate, and municipal properties ranging in size from

10 to 5,750 acres. He currently manages nearly 35,000 acres of forestlands, on which he provides such services as 10-year forest management plans, silvicultural prescriptions for multiple objectives, timber appraisals, pre-commercial thinning, reforestation, and weed control.

In addition to his work with landowners, Stephen teaches continuing education classes to both foresters and landowners, has authored many publications and performs a wide variety of forestry-related volunteer work. He received a BS in Environmental and Resource Management (Forestry) from the State University of New York College of Environmental Sciences and Forestry and a Teaching Certificate in Biology from Lycoming College, Williamsport, PA. Stephen has been a member of SAF since 1976. ❄

(continued from page 15)

Election to Fellow in the Society of American Foresters is the highest form of recognition from one's peers. The fellow award is limited to less than 5% of the National SAF membership. Two Allegheny SAF members were elected in 2004; both are shown below with Allegheny SAF Chair Ken Jolly.



Eldon R. Plaughter (right, above) is presently Land Agent for the central forest region of the MeadWestvaco Corporation in Elkins, West Virginia. He has been a member of SAF since 1972. He has held numerous lead positions as an employee of Westvaco since 1975, from district land surveyor, area forester and supervisor, land acquisition specialist and forester on the company's Wildlife and Ecosystem Research Forest.

Prior to employment at Westvaco, he was at the Glenville State College Dept. of Forest Technology, and experienced summers in the Monongahela National Forest on the Cheat Ranger District and the Fernow Experimental Forest. Eldon holds a BA in business management/accounting from Glenville State College, and an AAS in Forest Technology. He is a licensed forester and surveyor in West Virginia.

Eldon has served on the Stewardship Advisory Committee of the Fernow Experimental Forest and assisted West Virginia University Extension in the preparation of two videos for the advancement of public awareness in forestry: *Forest Management—Best Management Practices* and *Water in the Forest*.

Activities in SAF include: Chair of the WV Division of the Allegheny SAF; WV Committee leadership in the Registration of Foresters, served on the WV Division Executive Committee for seven years. He is affiliated with the WV Forestry Association, the WV and National Association of Land Surveyors and the American Congress on Surveying and Mapping.

At the community level, Eldon has been an active 4-H leader as coach of the forestry judging team, coached Little League baseball, is a past president of the National Wild Turkey Federation WV Chapter and is on the Land Resources advisory Committee of Glenville State College.



Mark C. Vodak CF, (right, above) has been Associate Professor/Extension Specialist, Forestry, at Rutgers University since 1990 and served as interim department chair for one year. Prior to his career at Rutgers, he was Assistant Professor at Virginia Tech, and a Research Assistant at Michigan State University. He's been a member of SAF since 1974, is a Certified Forester and has attended 19 National SAF Conventions.

Education: Michigan State University, PhD Forest Management; MS Forest Management; BS Forestry, North Carolina State.

SAF and Forestry Profession: Nationally. Mark has been the extension contact for the *Journal of Forestry* since 2001. He was a House of Society Delegate, Working Group Secretary, Education and Communication and Nonindustrial Private Forestry. He currently serves as Allegheny SAF continuing education coordinator, was Vice Chair, Chair, and Immediate Past-chair. NJ Division Executive Committee, Vice Chair, and Chair.

Professionally, Mark has been active internationally, nationally, regionally and statewide, participating in the IUFRO non-industrial private forestry symposium in Australia as well as USDA-CSRESS renewable Resources Extension Act strategic planning workshops. He is a frequent *Journal of Forestry* reviewer, and has over 232 articles/publications and 340 presentations, seminars, and programs for landowners and professional foresters to his credit.

Mark has received many awards, including the NJ Division SAF Appreciation award and Service award and Rutgers University Faculty Merit Awards six times. Locally, Mark serves on the Ocean County Agriculture Development Board, the Plumsted Township Natural Lands Advisory and Agricultural Committees.

History of Pennsylvania Forests

Educational Video/DVD



A newly produced program on the history of Pennsylvania's forests is now available. Offered in both video and DVD format, it is especially suitable for educators, forest landowners, foresters, and the public. The program depicts how past land use has formed today's forests and explains the role of forest management in sustaining our forest ecosystems into the 21st century. The production was written and narrated by former State Forester, Jim Nelson. It includes a professional quality, half-hour long video segment suitable for airing on a local television station, as well as a slide show. The production is a joint effort of the The Allegheny Society of American Foresters (Pennsylvania Division), U.S. Forest Service, Pennsylvania Department of Conservation and Natural Resources (Bureau of Forestry), and Penn State's School of Forest Resources.

"Pennsylvania Forest History with Jim Nelson" Video/DVD Order Form

Name: _____

Address: _____

City: _____

State: _____ Zip: _____

Phone: _____ E-Mail: _____

CIRCLE ONE:

VIDEO

DVD

Please send me _____ copies of the History of Pennsylvania's Forests with Jim Nelson. Cost including shipping and handling is \$25.00 per video or DVD. Please include a check or money order with your purchase. For more ordering information please email Doug D'Amore at djdamore@verizon.net

MAKE CHECKS PAYABLE TO:
Society of American Foresters PA Division

MAIL TO: Doug D'Amore
2042 Delaware Avenue
Renovo, PA 17764
H: (570) 923-1517
W: (570) 923-6011

Allegheny SAF 2005 Winter Meeting Photos

Photos courtesy of Alex Day and Jack Winieski

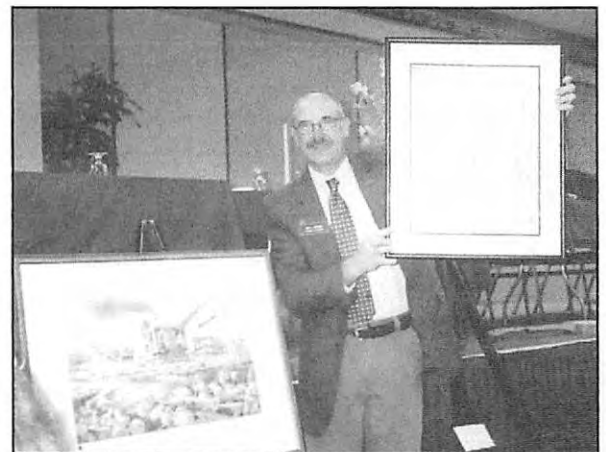
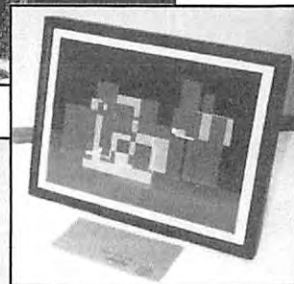

Allegheny SAF 2005 Winter Meeting Photos

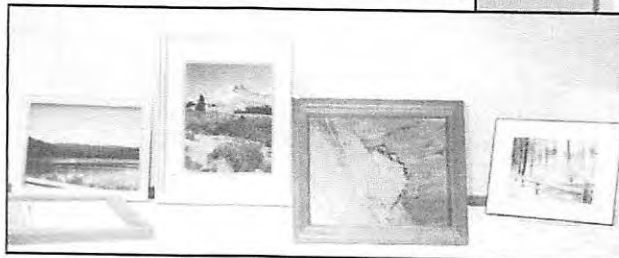
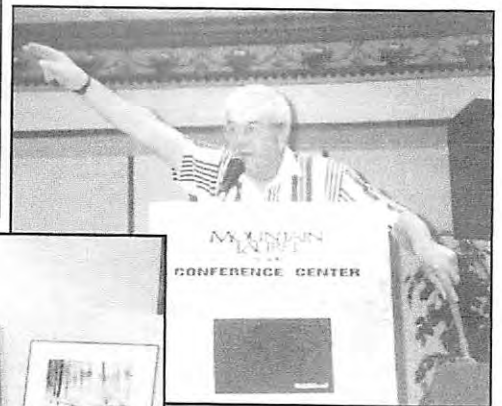

Allegheny Society of American Foresters

Executive Committee Meeting Minutes of February 23, 2005

Attendees: Allegheny Officers – K. Jolly, Chair; K. Steiner, V. Chair; R. Billingham, Sec/Treas; K. Kane, Pst. Chr; R. Siefert; M. Fajvan; J. Perdue; T. Kaden; N. Karger; M. Webb; and H. Wurzbacher; Exec. Comm. Members: J. Winieski, Exec. Dir.; M. Lester, Council Rep. **Division/Chapter Officers & Committee Representatives** – D. Galway, NJ Div.Chr.; F. Hennion, NJ Vice.Chr.; S. Resh, MD/DE Chr.; D. Miller, PA Div.Chr.; B. Elison, PA Div.Chr.Elect; E.R. Plaughner, standing in for WV Div. Chr.; R. Cary, Pinchot Chr.; N. Lylo, Pinchot Chr.Elect; C. Stelter, PA Plateau Chr.; M. Buccowich, PA Valley Forge Chr.; C. Ostheim, W.Gateway Chr. **Other Attendees** – M. Goergen, SAF EVP; M. Morgan, SAF Conventions: K. Gottschalk, 2006 Conv. Arrangements Chr.; G. Pierson, NJ; and W. Rossman, W.Gateway.

Minutes from Previous Executive Committee Meeting:

No discussion; approved as published in the Allegheny News.

Treasurer's Report (R. Billingham):

2004 Treasurer's Report was reviewed and approved. End of the year balances: Checking: \$12,176.38; Endowment Savings: \$13,841.92; Endowment CD: \$29,224.08. Current Treasurer's Report was reviewed and approved. Current Balances: Checking: \$14,601.67; Endowment Savings: \$4,176.18; Endowment CD: \$41,360.

Council Report (M. Lester):

VOS Task Force Report – ASAF Exec. Cmte. voted to hold off on approving the report until HSD has a chance to meet. The new structure is intended to focus more attention on regional and local units, increase participation of students, and ease the burden of the SAF President. The next Council meeting is in March and a more serious look at the report will take place in June. Council does not intend to take action to consider the recommendations until the December Council meeting. There is a concern with the idea of regional meetings in place of the national meeting every other year. Council is urging members to read the report and respond through their channels. **Member Retention** – This is a big concern at all levels of membership, as SAF is struggling with how to retain members. The greatest loss of members is from student to professional membership. Membership remains most solid after 11 years of membership. SAF needs to decide whether it wants to have a small vision or wider vision of the profession. We need to be aware of colleagues who are not members and encourage them to join. Consider creative ways to encourage membership and ways to make SAF continually relevant to current and prospective members. **Leadership Academy** – Leadership Academy is June 11–15, 2005. ASAF should support another two people to send this year. Urge your divisions/chapters to send someone, if at all possible. Keep your eye on possible leaders, even if they are not yet in leadership positions. D. Galway suggested presenting an award to an outstanding forestry student, and part of the award could be Leadership Academy attendance. **Field Forester of the Year Award** – We still need nominees for this award. There are many qualified people in ASAF, they just need to be nominated. The ultimate due date is June 15, but get your nomination information in to M. Lester by May 15. Please try to flesh out additional information on the form. Check the SAF website for award qualifications.

National SAF Update (M. Goergen):

Membership is in decline. The National Office is working on curbing expenses, and will have a positive bottom line at the end of 2004 (between \$100,000 and \$200,000). The Forester's Fund is not providing grants in 2005. The fund is in an S&P 500 Index fund, which takes a five-year rolling average. If the return is positive, that excess is used to fund Forester's Fund projects. The five-year average was negative in 2004, so no funds were available. This is not expected to happen again next year. Many positive things were accomplished with the fund in 2004.

National Convention 2006 Update (M. Morgan):

The National Convention will be hosted by the ASAF October 25–29, 2006 at the Pittsburgh Convention Center. Preparations are well underway. The program committee meets to look at the big picture of the convention: general session speakers/theme/etc. The first marketing push will be at the 2005 convention in Ft. Worth, where we will have booth in the exhibit hall. In the fall of this year, there will be a call for presentations and posters. In the winter, SAF staff will put out an exhibitor prospectus to 1000 exhibitors. In spring 2006, *The Source* will have program info and

early bird registration will begin. ASAF will receive a copy of the 2006 manual that has a convention model showing how the convention works and how much time it will take for each of the major roles ASAF will take part in. We will need to market the convention locally. We can ask neighboring societies for help, but if we do so, we should give them a portion of the funds we receive. K. Gottschalk is the Convention Arrangements Chair. J. Finley and S. Stout are working on the scientific program. K. Steiner is General Chair. If you would like to be involved in any way, please contact K. Steiner via e-mail and indicate the area in which you would like to be involved. K. Gottschalk needs suggestions for tour stops for the working group tours and wants to put tours together of interest to various groups of people.

Committee Reports:

Awards (H. Wurzbacher) – There was a good response to the call for nominations this year. The Outstanding Service to Forestry award was given to Bob LaBar and they were able to expedite arrangements so that the award was presented to him before his death. Thanks to the committee for making this possible through their quick action on this matter. The Service Forester of the Year award will go to Bob Williams.

Communications (R. Farr, via proxy) – The National Office no longer has an in-house communications person, they are now outsourcing most communication work.

Education (M. Webb) – No activity to report.

Endowment Fund (R. Sheay, via proxy) – Because we are very close to our endowment fund goal, R. Sheay suggests that we discharge the ad hoc committee. Note that there is a Merrill Lynch account with almost \$5,000 in it that needs to be shifted over to the treasurer.

Membership (K. Steiner) – ASAF is now ahead of last June's count, but the member purge happened before June. We are not too far behind where we were last April. The registration table has lists of members and info on recruiting. Look over the membership list; if people you know aren't on the list, contact them.

Nominations (K. Kane) – ASAF needs people that are interested in running for office. If you know someone who might do a good job, contact K. Kane.

Program (N. Karger) – Summer 2005 will be in Erie, PA and will be hosted by the Plateau Chapter. Winter 2006 will be hosted by the Valley Forge Chapter. Summer 2006 will be cancelled due to the National Convention in Pittsburgh. MD-DE will not be hosting winter 2007. NJ would like to host a summer meeting. N. Karger will be updating the meeting planning guide and will send it out for the Exec. Committee's review. K. Jolly will send the operations manual out to all new officers. Note that M. Goergen will be a speaker at the Roach-Bauer Forestry Forum.

Student Mentor Program (T. Kaden) – The program began with 50-60 students and is now at 6 students, so he will not be doing the program this year. If anyone would like to resurrect it at some point, let T. Kaden know. T. Kaden is acknowledged for working on this program.

Student Quiz Bowl (S. Resh) – S. Resh has been asked to take over the quiz bowl. We need to elect a new chair for this committee. If you are interested in judging, contact S. Resh.

Executive Director Report (J. Winieski) – Paper donations for the *Allegheny News* continue to be a problem. MeadWestvaco has offered to finance one issue per year with \$500. We are always looking for ads. So far, only one person has responded to the idea of an e-mail newsletter. J. Winieski can send some extra copies of the newsletter to whoever needs them. The next deadline for the newsletter is March 15th. We received a letter from the Teachers for the Forests asking us to join again; they are active in WV. Winieski periodically receives requests for harvesting ordinances. Perhaps we should think about a committee regarding harvesting ordinances.

Old Business:

HSD Report (K. Jolly) – all ideas that reached K. Jolly have been passed along to HSD. Continue to send your ideas in to him. Contact K. Jolly if you would like a copy of the report he handed out at the meeting.

Bob Bauer Scholarship/Student Award (M. Webb) – We will be able to make our first award for this scholarship this coming fall.

Goddard Chair Sponsorship at PSU (M. Webb) – ASAF will be listed on the plaque next to the door of the Goddard Chair's office in the new forestry building at PSU. If you would like to donate, contact M. Webb.

(continued on page 18)

(Continued from page 21)

Old Business (continued):

ANSAF Mail Server (K. Steiner) – The server is up and K. Steiner's secretary will keep it updated. K. Jolly can post to it as well as K. Steiner and J. Winieski. This listserv appears to cover all but 27% of the membership. We could supplement our usual activities with notes over the listserv. Any text desired to post to the listserv should go to K. Steiner. Thanks to K. Steiner for getting this up and running.

Forester Fund Grants:

PA – History of PA Forestry Video (D. Miller): The video is complete and will premier tomorrow after lunch. They are working to sell all the copies. It is targeted to educators. Consider buying a copy for your local library or school district. It is 26 minutes in length, so it can be shown on public TV. It would cost an additional \$3,500 to produce on DVD. A fact sheet to accompany the film is in the works.

NJ – Get the Word Out on Forestry in NJ (D. Galway): A position statement was sent out to all boards in NJ. They set up a booth at the NJ League of Municipalities. A brochure was produced to hand out at the meeting (We Work Where You Live and Play). As a result of this effort, one municipality decided to hire a forester and several others are looking at having Stewardship plans written.

New Business:

Golden Member Certificates (K. Jolly) – There are four golden members this year: Robert H. Brommer, Jr. (Keystone), Keith D. Horn (Northern Hardwood), R. Joe Johnson (West Virginia), and Harry B. Mahoney (West Virginia). These awards will be given out at the banquet tomorrow. Awards for recipients not in attendance will be accepted by their respective division/chapter chairs and will be given out at an opportune time within the local division/chapter.

Allegheny Endowment Fund Name (K. Jolly) – There was a proposal to change the name of the Endowment Fund to honor R. Sheay for his hard work in that arena. This proposal was withdrawn from consideration by R. Sheay.

Reginald Forbes Art Contest (K. Jolly and R. Cary) – There was a proposal to re-name the contest to the Forbes-LaBar Art Contest. It was decided that we would keep the name the same and then give an award in Bob LaBar's name for a certain category of art. A sub-committee should be formed to review this situation and report back at the next meeting. The sub-committee will also look at future funding and streamlining of the process. A motion was passed to move these functions into a sub-committee. Anyone interested in that sub-committee should contact C. Newlon.

Leadership Academy (K. Jolly) – This year the academy takes place June 11–14. Registration is \$310 and a room is \$450 for a double. If you are interested, send info to K. Jolly or M. Webb.

Awards Recipient Sponsorship for Awards Banquet (D. Galway) – Awardees should not have to pay for their banquet attendance (but can pay if they wish). The cost would be about \$100 for 2 awards per year, which would come out of the meeting costs, not a budgeted item. The meeting hosts would absorb this cost and a special invitation should be sent to the recipients. If the awardees have already paid, they can either be reimbursed or donate their funds. This motion passed with one negative vote.

ANSAF/NCSAF Presidential Field Forester Criteria (K. Jolly) – We want to make sure that all Council Rep. candidates from both regions get better exposure in each of the regions. A Presidential Field Forester Criteria Committee would have the option to make create new criteria for selecting a nominee for recognition. H. Wurzbacher will be the point person for this. Anyone interested should contact K. Jolly or H. Wurzbacher.

Fellow Nomination Process (K. Jolly) – There are two options to choose from at present, until the Fellow situation is fully addressed. Option 1: Allegheny can send one nomination for Fellow or Option 2: Allegheny can send one nomination form each division. You can nominate someone in another state but cannot vote for them, the voting would stay within the state. There was a motion to choose Option 2. That motion carried 17 to 6.

Approval of 2005 Budget (K. Jolly) – The Executive Committee reviewed and approved the budget status report prepared by the Treasurer. MeadWestvaco has agreed to donate \$500 per year as a donation for the paper needed for one issue of the *Allegheny News*. Note that ASAF will be reimbursed at least \$750 of seed money from this meeting. It was decided that we will print only three issues of the *Allegheny News* this year and the summer issue will go out electronically using the listserv. This issue will be abbreviated and will be text only. R. Billingham will be responsible for

making sure that members without e-mail addresses receive printed copies through the mail.

Division/Chapter Reports:

WV (E. Plaughter) – The winter meeting was very successful.

MD-DE (S. Resh) – The division had a great meeting in November regarding timber trespass. They also participated in a legislative breakfast this morning.

NJ (D. Galway) – They are working hard to conduct outreach to municipalities. They are meeting on the issue of watersheds in the NJ Highlands. The Highlands Protective Area legislation passed

PA (D. Miller) – Most of the attention has been on the video lately. Be sure to purchase your copy.

Plateau (C. Stelter) – They will be hosting the summer meeting in Erie from July 27-29.

Valley Forge (M. Buccowich) – They are hosting the winter 2006 meeting in Lancaster at the Eden Resort.

Pinchot (R. Cary) – Has been very busy with the current meeting.

Adjourn: K. Jolly adjourned the meeting at 8:00 pm.

General Business Meeting Minutes February 25, 2005

The General Business Meeting was conducted by K. Jolly, Chair, who called upon Executive Committee members present to provide the membership with a brief report on Exec. Comm. discussion items from Feb. 23, 2005. The Pinchot Chapter Winter Meeting Planning Committee members were recognized and thanked for their diligent efforts in planning a very successful and interesting meeting. K. Jolly noted that Mary Coulombe is running for Council and that the National Capital August meeting can be a forum for any Council nominees. Following this, the floor was opened for new business items from the membership present. D. Miller: The PA Forest History film will be available on VHS or DVD at the Forest Issues Conference. Anyone wanting to volunteer for the 2006 National Convention should contact K. Steiner or K. Gottschalk. We especially need 6-8 people to man the booth at Ft. Worth. K. Kane: mentioned a possible dues increase to help with our budget problems. Another possible solution could be to tack on a couple of extra dollars to the registration fees for the meetings. Perhaps a \$2.50 increase for all Allegheny members. We should put this on the agenda for the summer meeting. 🌿



THE NELSON PAINT COMPANY

From the first name in forestry paint - Nelson Paint has been making high quality forestry paints and products for over 60 years.

Nelson Paint and Equipment offer:

Vibrant, non-absorbing colors
Easy application with Nel-Spot gun
Long-term and short-term marks

BUY FACTORY DIRECT
at
1-800-236-9278
or online at
www.nelsonpaint.com

Field Forester of the Year Award Nominations Due

Nominations for the 2005 Presidential Field Forester of the Year are due by May 31, 2005. The purpose of the award is "to recognize foresters who have dedicated their professional careers to the application of forestry on the ground using sound, scientific methods and adaptive management strategies. The Presidential Field Forester Awards will be presented to individuals who have displayed uncommon talent, skill, and innovative

methods to achieve a record of excellence in the application of forest management."

There is one Presidential Field Forester of the Year award presented in each Council District. District VII, The Allegheny and National Capital Societies, solicits candidate nominations to be directed to the State Society Chairs for award consideration.

ELIGIBILITY CRITERIA

- Must be a member of SAF (state year of joining).
- Must have practiced forestry in the field for at least 10 years.
- Management intensity may range from very intensive applications to more extensive management regimes.
- May be from any employment sector.

CAREER NARRATIVE

Please provide a statement, no longer than two pages, outlining the nature of the candidate's accomplishments. The narrative should include statements showing:

- Documentation that the candidate has practiced field forestry in a truly outstanding manner through use of unusual talent, skill, and innovative methods.
- Candidate understands and used science along with adaptive management processes to achieve landowner objectives in the context of promoting forest sustainability.
- Candidate is recognized, locally or regionally by peers, for excellence in field application of forestry.

RECOGNITION

Individuals recognized for the Field Forester Achievement Award will be announced and recognized at the Annual SAF National Conventions during the Awards Ceremony, and when appropriate, at local SAF functions. A short biographical sketch with personal photo together with highlights describing each recipient's career will be printed in the Convention Awards brochure and accompany the award.

Nominations need to be received by individual Society Chairs by May 31, 2005. Society Chair addresses can be found on page 32 of this newsletter.

Nominations in electronic format are preferred, but hard copy will also be accepted. There should be no shortage of nominations from these two fine Societies. ❄

Winter Meeting Exhibitors and Sponsors

The 2005 Allegheny SAF Winter Meeting was a success in many ways, not the least of which was financially. We owe a great deal of thanks to the exhibitors and sponsors for their attendance. Consider their products and services when they fit your particular needs.

Alenza - Todd Hagenbuch
570-459-5048
thagenbuch@dbiservices.com

Island Press - Krista Fisher
202-232-7933
kfisher@islandpress

PA Biodiversity Partnership
Sue Thompson
412-481-4100
Thompson@pabiodiversity.org

Bark Mark Timber Marking Paint,
NCP Coatings - Tom Creed
1-800-627-1948
info@ncpcoatings.com

Liquid Fence Co. - Donna Roy
1-800-923-3623
donna@liquidfence.com

The Nature Conservancy - Ellen Lott
570-643-7922, ext. 20
elott@tnc.org

Cuesta Systems Inc. - Barry Costello
905-333-4544, ext. 12
barrycostello@cuestasys.com

PA Land Trust Association (PALA)
Andrew M. Loza
717-230-8560
aloza@conserveland.org

The Nelson Paint Company
Laurie Massicotte
906-774-5566
massicottel@nelsonpaint.com

2006 SAF National Convention in Pittsburgh

By Kurt Gottschalk, Local Arrangements Chair, 2006 SAF National Convention, Pittsburgh, PA

As many of you are aware, the Allegheny SAF will host the SAF National Convention in Pittsburgh on October 25-29, 2006. The General Chair of the Convention is Dr. Kim Steiner, Penn State University. Drs. Susan Stout, USDA Forest Service, Northeastern Research Station, and Jim Finley, Penn State University are the co-chairs of the Program Committee, while Dr. Kurt Gottschalk, USDA Forest Service, Northeastern Research Station is the Local Arrangements Chair. Email addresses for all four are listed below.

The Program Committee will be meeting at SAF Headquarters on May 20, 2005. Any suggestions on a meeting theme, keynote speakers, and plenary session speakers should be forwarded to Jim or Susan before May 16, 2005.

The 2006 Convention Executive Planning Committee will be meeting in State College, PA on May 16, 2005. We will be developing our recommendations for Susan, Jim, and Kim to take to the Program Committee meeting at that time. Also, we will be developing our timeline of activities and volunteer needs.

Local Arrangement Committee Tasks

The Local Arrangements Committee is responsible for six areas at the SAF National Convention:

1. on-site management of the Foresters' Fund during 2006 convention
 - a. requires a committee chair to coordinate activities and volunteers
 - b. requires 12-18 volunteers during 2006 convention
 - c. requires members to solicit donations for the raffle/auction
2. secure and train volunteer assistance during 2006 convention
 - d. requires a committee chair for volunteers
 - e. requires volunteers for registration (10-15), hot shot (6-8), speaker ready room (6-8)
3. market 2006 convention locally/regionally (within 5state Allegheny Society)
 - f. requires a committee chair to coordinate communications
 - g. requires 2-3 volunteers to staff the press room during 2006 convention
 - h. requires a committee chair to coordinate marketing
 - i. prepare promotional materials for booth at 2005 convention
 - j. secure and train volunteers for promotion booth at 2005 convention (4-6 volunteers)
4. research, develop, and manage the Technical Field Workshops on the last day of the 2006 convention
 - k. requires a committee chair to coordinate workshops
 - l. create 6-8 one-day technical field workshops
 - m. manage technical field workshops, one volunteer per workshop to be leader
5. plan and manage student activities including Quiz Bowl (in cooperation with host student chapter)
 - n. requires one volunteer to coordinate Quiz Bowl and National Student Assembly
 - o. coordinate student volunteers from the host student chapter
6. secure and train volunteers for companion room during 2006 convention
 - p. serve as hosts in the companion room (2-4)
 - q. organize informal activities for those not attending leisure tours

What we need to do in the next six months:

1. we need to select 6 committee chairs (volunteers, Foresters' Fund, marketing, communications, technical field workshops, and student activities)
2. we need suggestions for technical field workshop stops and speakers within a two-hour bus ride of Pittsburgh
3. we need suggestions for leisure tour stops within the greater Pittsburgh area
4. we need 4-8 volunteers for our promotion booth at 2005 convention
5. we need indications of willingness to serve as committee members and volunteers during the convention.

Please contact Kurt Gottschalk via email or phone to volunteer any of the items needed in the next six months.

General Chair	Kim Steiner	steiner@psu.edu	814-865-9351 (office)
Program Co-Chairs	Susan Stout	sstout@fs.fed.us	814-563-1040 (office)
	Jim Finley	fj4@psu.edu	814-863-0401 (office)
Local Arrangements Chair	Kurt Gottschalk	kgottschalk@fs.fed.us kwgottschalk@greenepa.net	304-285-1598 (office) 724-627-4161 (home)

The Paradox of Sustainability

James P. Hamilton, Penn State Mont Alto

Is sustainability inevitable or impossible? I think the answer is yes. Simply put, the paradox of sustainability is that given current human attitudes and technologies, sustainable human activities are, for the moment, impossible; while at the same time, given the law of conservation of energy (the first law of thermodynamics) they are, barring extinction, inevitable.

First let me define sustainability as I am going to speak of it in this effort. You can disagree with the definition, but I want to make sure we begin with some understanding of my usage. Let me do this with an analogy. If you are given one million dollars (tax-free) to put in the bank at 6% interest, you will receive \$60,000 per year. In this analogy, you represent all of humanity, the bank and the million dollars represent the planet and its interest producing resources, the interest represents the resources we can afford to make use of (consume if you will), and the external economy that produces interest for the bank represents the incoming energy from the Sun, and nominal amounts of other energy. As long as you do not spend more than \$60,000 per year, you can, in theory, continue to receive that amount in perpetuity. Of course, this assumes there is no catastrophic failure of the bank or the economy, which would be analogous to a comet hitting the Earth, or some other major catastrophe. However, if you spend even as little as \$60,001, you will eventually run out of money since that one dollar represents a piece of your principal. Should you be foolish enough to spend \$250,000 per year, you would soon be quite broke.

Now let's assume that when you go to the bank to get your \$60,000 you break down the door when you leave. As a result, the bank has to spend some of your principal or divert some of your interest to cover the costs of the damage. In effect, you have just exceeded your maximum sustainable allotment of \$60,000. If you do the same thing the next time and maybe break a few windows or steal a few bricks as well, then the amount of interest you receive is even less, and the bank is spending even more of its resources fixing itself. If you continually damage the bank each time you make a withdrawal, eventually the bank will be spending so much of its interest fixing itself that there is nothing left to give to you and, additionally, the bank will be a dangerous place to visit. You can only remove so many bricks, after all. Both you and the bank are bankrupt. Since for any given generation, it is imperative that we get the bank's interest NOW, and since you cannot wait for the many years it

might take the bank to recover and repair itself, you are in trouble.

This is the definition of sustainability I am going to use: living off the interest of the planet without damaging the planet's interest-producing capacity. And it brings me to three

rules for assessing the sustainability of any enterprise. First, we must never use nonrenewable resources in non-recyclable ways: you cannot burn oil, coal, and gas for example. Second, we must never use renewable resources in non-regenerative ways: you cannot cut trees faster than they can regenerate. And third, in doing the previous two, we must not damage the planet's regenerative capacity, its capacity to create interest: we cannot reduce biodiversity or pollute the planet beyond its healing capacity, as two examples.

For purposes of this discussion (since this part of it is admittedly anthropocentric), I will define renewable resources as those that can be fully regenerated in about one to three human lifetimes, in other words, about 80-240 years. If you wish, you can alter the range of time by some hundreds of years and most of what I am saying will still apply. Nonrenewable resources are those that cannot be regenerated in fewer than many hundreds or thousands, and usually many millions, of years, a time span generally beyond the consideration of practical human needs. For any given generation, it is imperative that it has the capacity to harvest the resource interest NOW. Of course, for all subsequent generations, the same is true.

There are a number of implications in both the rules and the definitions. First, you cannot have an infinitely expanding ANYTHING on a finite planet, including the economy or the human population. Second, you cannot infinitely extract finite resources; every third grader knows that. Third, you cannot infinitely expand the carrying capacity of the planet, the green revolution



notwithstanding. And fourth, for any type of organism, there are only two alternatives, sustainability or extinction.

Since I am not going to argue for the extinction of humanity, I must be arguing that human sustainability is inevitable. The only question is, "what will it look like when we get there?" Right now, non-sustainable behavior is not only normal, it is applauded. That must stop. The only sustainable scenario that is appealing is what I call humane sustainability, a future in which we live well within the carrying capacity of the planet. It is a future that includes ecological diversity, a stable population, freedom, justice, art, and all of the things that make us distinctly human and make life worth living. This is a future very different from Easter Island, for example, where the people so damaged their lush little island (planet) that they could barely eke out a hardscrabble existence. We have a very long way to go to get there, a longer harder road than we have come so far.

I cannot think of a more important group of professionals than foresters or a more important profession than forestry to help achieve humane sustainability. First of all, foresters are light-years ahead of most others in their understanding of the need for and methods to achieve sustainable resource extraction. You are the keepers of the bank and the fact that nearly everyone else fails to see the need for keeping the bank viable, makes your vision and abilities all the more important. Of course, there will be plenty of debate about how to get there, about what is or is not a sustainable forestry practice, about particular strategies. Mistakes will be made. But forestry is a science and science is self-correcting when done right.

We cannot have a sustainable future without sustainable forests. The question should no longer be about whether sustainable forestry is advisable. There can be no doubt. Like everything else, you either have sustainable forestry or no forestry. The kind of sustainable future we end up with will be much better because of foresters than it would otherwise be. It was an honor to speak at the banquet on February 24, 2005 and enlightening to speak with many who were there. Knowing what you do and how dedicated you are to your profession gives me great hope that at least one part of this world society is moving in the right direction. ✎

Allegheny SAF Elections in September 2005

The Biennial elections for the Allegheny SAF will be held this coming September. The Chair-Elect, Secretary/Treasurer, and Executive Committee member positions will be on the ballot.

If you would like to be considered for one of these positions to serve your professional society, contact Ken Kane, Nominations Chair at 814-837-9391, or see him at the July meeting in Erie, PA. ✎

"I got into this business because the tree protectors my customer was using killed over half his trees."

Tom Mills
Tree Pro President



"So I started designing and testing my own protectors. Eventually, I came up with a design that did the job it was supposed to.

"There are just too many variables that affect tree health and growth to rely on guesswork. To truly know what works, you must exhaustively test each product.

"That same philosophy applies to all our products: time-release fertilizer, root dip, inoculants, soil softening agents, weed mats, etc.

Choose tree enhancement products with the same care you choose your trees.

"Planting trees can be a huge investment in time, money and effort. To not protect them from deer and other animals, to not give them the best start you possibly can, is to throw caution to the wind."

Ask about our \$99 Plantation Starter Kit, which includes 10 GSP black walnut trees along with all the thoroughly tested tree enhancement products you need to get started.

Tree + Pro

3180 W 250 N,
W. Lafayette, IN 47906
800-875-8071
www.treepro.com
sales@treepro.com

A Little History

By Robert Rumpf

One of my first activities when we started to work the shore, about 1957, was to get around and meet the various foresters who worked in the field for the State of Maryland, people from the Soil Conservation Service and other resource agencies. When we started to move into Delaware I arranged to meet Bill Taber, State Forester of Delaware, who had his office in Dover. At that time the Delaware Forestry Department consisted of three professionals: Taber, Charlie Goodrich, who was assistant State forester and forester Walt Gable. To hear Walter talk took care of just about everything that came along out in the field.

Entering Taber's office was like entering a time capsule from the early 1900's. It was what I imagine an early Forest Service office would have been like with a bunch of big sugar pine cones and other evidence of the woods sitting around on shelves. After I introduced myself, one of the first things Taber said to me was, "Do you carry a pocket knife?" When I pulled my knife out and showed it to him he said, "Good, I wouldn't hire a forester if he didn't carry a pocket knife." So I guessed I passed the first muster.

The above is from a series of "historical vignettes" written over time by Bob Rumpf, relating some of the experiences and characters he remembers from his years with the Glatfelter Pulpwood Company. I thank him for sharing part of that history – history from the standpoint of the times, technology and people we all shared over our years of practicing this science-based art we call forestry. If you have similar short tales you wish to share with the rest of newsletter readers, please send them to ansaf@baonline.com (as a Microsoft Word attachment) or The Allegheny News, Box 699, Dillsburg, PA 17019. Ed.

Sometime later I had occasion to see Taber and he said he wanted to show me something. We went out to the Redden State forest and took a trail back through the woods and came upon a several acre white pine plantation about five to six inches DBH. Bill said that a New England Forester would be proud of the plantation for it did not have any problems with white pine weevil. Of course the reason it did not, was that there wasn't any other white pine within miles – so there was no way for the weevil to get there.

Scattered among the white pines were a number of volunteer loblolly pines that seeded in after the white pine seedlings had been planted; many of the loblolly were eight to ten inches DBH. Taber asked me what I thought. I said it looks like you should have planted loblolly. That definitely was not the right answer and I did not pass the muster on that one! Later, I understand, he sent a crew in and cut out all the loblolly and just let them lay so as to not harm the white pine in removing the wood.

All in all, in his way, Bill Taber was a good man and he did give me some good help in getting started on our land acquisition program in Delaware.

Robert H. Rumpf, January 1998

MD DNR Forest Service Assumes Management of Forests

Annapolis, MD – Reiterating its commitment to both improving government efficiency and maintaining the stewardship of one of its most precious natural resources, the Maryland Department of Natural Resources today announced that its Forest Service will assume management responsibility of Maryland's State Forests. Until now, DNR's State Forest and Park Service has been managing these properties, which include Green Ridge State Forest in Allegany County, Potomac-Garrett and Savage River State Forests in Garrett County and Pocomoke State Forest in Worcester County. The transfer of management responsibility is effective immediately, but an inter-agency transition team composed of members of both units will work together to implement the transfer between now and July 1, 2005.

"The Forest Service has greater scientific, academic and professional expertise in the newest approaches to

sustainable forest management," said DNR Assistant Secretary Michael E. Slattery. "The Partnership for Sustainable Forestry [PSF] welcomes the forests back to the Forest Service," said Gary Allen, PSF Chairman. The Maryland Park Service will continue to have management responsibility for their 49 parks, natural environmental and resource areas and marinas.

The assumption of forest management by the Forest Service will have no impact on forest harvesting, and personnel will be shifted between the units as necessary to achieve forest sustainability goals as set forth in the Sustainable Forestry Initiative and Forest Stewardship Council Certification Standards. "We are ecstatic at the prospect of managing Maryland's State Forests and we thank the State Forest and Park Service for being excellent stewards of these precious natural resources," said State Forester Steven W. Koehn. Learn more at www.dnr.maryland.gov #

WATERSHED SUPERVISOR NEEDED

Skilled professional, technical and supervisory position available at City of Bethlehem watershed with responsibility for supervision, planning and application of modern technical forestry standards in maintenance of City's watershed forests as part of sustainable forestry initiative to ensure water quality. Position may start on a part-time basis as training period with incumbent's expectation of full-time employment. Responsible for managing and inspecting operation and maintenance of City's two drinking water dams, reservoirs, water diversion facilities and transmission mains. Must be technically competent in equipment and SCADA computer system repair procedures. Serves as City's Urban Forester. Involves oversight of Shade Tree Ordinance, street tree improvement programs, performing inspections and administering examination for licensing of tree surgeons. Work involves considerable physical exertion and climbing over rough mountainous terrain. Must be computer literate; good supervisory skills. Must have working knowledge of water chemistry and bacteriology. Graduation from college with major work in forestry with considerable forestry experience, or any equivalent combination of experience and training. Excellent fringe benefit package. Full-time annual salary range of \$41,848 - \$58,830. Send cover letter and resume to Jean Zweifel, Dir of HR, 10 E Church St, Bethlehem, PA 18018 or email to zweifjeaa@bethlehem-pa.gov. The City is in immediate need of this position.

EOE

Come Join Us For The

Allegheny SAF 2005 Summer Meeting

Hosted by the Plateau Chapter on July 27, 28 and 29, 2005
The Avalon Hotel & Conference Center, Erie, PA

Presque Isle and Beyond: Biodiversity and Forest Management

Just a few of the highlighted topics include:

"Aquatic Invasive Species of Pennsylvania and Ecosystem Effects"

"Impacts of Small Scale Silvicultural Disturbances on Forest Interior Birds"

"Invasive Exotic Plants in Forests:

A Summary of Current Research in Northeastern Research Station, USFS"

plus field trips and more....

Block room rate \$79/night (plus tax). Reserve directly with the Avalon Hotel and Conference Center.

Call 814-459-2220 or toll free 1-800-822-5011. Visit their website: www.avalonerie.com

More details including reservation form to follow... watch your mailbox, and see you there!

Forest Biodiversity and Deer

By Mary Ann Fajvan, Allegheny SAF Forest Science Coordinator

For those of you who were unable to attend the Allegheny Winter Meeting, the program generated much discussion about different aspects of biodiversity. One topic common to most of the presentations was the role of high white-tailed deer densities in the seriously degraded ecological conditions of many forests in our region. Even though trees dominate the structure of the forest, they are intricately linked to the many other living and non-living components. Each layer of the forest, from the canopy to the soil, provides habitat for a group of specialized plants, animals, and micro-organisms.

Overbrowsing by deer has been shown to impact, tree, shrub, herbaceous, bird, and small mammal components of the forest ecosystem and cause major changes in forest structure. Although ecosystem function is harder to measure, browsing-caused changes to mineral recycling have been documented. It is not clear how quickly restoration of full forest structure, species diversity and function can be achieved once deer numbers are reduced to appropriate levels. Nor is it clear how low deer numbers will need to be to achieve recovery of the forest ecosystem.

The length of time that a forest has been subjected to overbrowsing and the extent to which a dense layer of unpalatable vegetation has developed are major variables that will influence recovery time. Such "legacy effects" of overbrowsing also include declining seed availability and reduced root-sprouting potential. There has been little or no research on certain key biological issues such as how long various native plant species persist as live roots in the face of long-term chronic browsing or how likely such root sprouts are to succeed, if deer densities were



Mary Ann Fajvan at the Allegheny SAF Winter Meeting

reduced. Silviculture studies have shown that fencing an area during a regeneration treatment allows tree seedlings to become established and grow above the browse line. However, after the fence is removed, highly preferred shrub and herbaceous species are once again subject to browsing. A more permanent solution is required to achieve ecosystem recovery.

In April 2001, the Pennsylvania office of the National Audubon Society and the Pennsylvania Habitat Alliance asked a group of professionals to look at deer management from an ecosystem perspective. The resulting Deer Management Forum was asked to describe how deer management might differ from current practices if deer were managed within an ecosystem framework that aims to conserve native biodiversity. Forum members reviewed relevant research, interviewed national experts, visited field sites and prepared a report on its findings and recommendations entitled: "Managing White-tailed Deer in a Forest Habitat From an Ecosystem Perspective - Pennsylvania Case Study". The report is a valuable reference for forest resource managers and I encourage you to visit the Pennsylvania Audubon website to obtain a copy.

The report is available for downloading (PDF) at pa.audubon.org

Coming Events

April

7 Roach-Bauer Forestry Forum, Michael Goergen, Jr., Exec. Vice-President and CEO, Society of American Foresters will give an overview of current forest policy issues from a national perspective. Kane, PA Country Club; for reservations call 814-837-8550

26-27 2005 Forest Resources Issues Conference hosted by Penn State University. "Pennsylvania's Forest Resources: Assessing Its Condition" at Nittany Lion Inn, University Park, PA. Contact Laurie Schoonhoven at 814-865-7932 or email at lms28@psu.edu

May

17 Oak Regeneration Workshop at the Ag Progress Days site, 2005 Penn State Eastern Hardwood Regeneration Institute. Mike Powell 814-863-1113 or email mjp175@psu.edu

31 Deadline for submission of candidates for Div VII 2005 National President's Field Forester of the Year award. Email Mike Lester to milester@state.pa.us

June

11-14 2005 SAF National Leadership Academy, Lied Conference Center, Nebraska City, NE. Louise Murgia, 301-897-8720 x 118 or email murgia@safnet.org

July

27-29 Allegheny SAF Summer Meeting, "Presque Isle and Beyond - Biodiversity and Forest Management," The Avalon Hotel & Conference Center, Erie, PA (see page 29)

September

15 Deadline for articles and photos for Fall 2005 issue of *The Allegheny News*

Future Allegheny SAF Meetings

Winter 2006 - Valley Forge Chapter

Summer 2006 - Cancelled because of the SAF National Convention hosted by Allegheny SAF in Pittsburgh, PA

Future SAF National Conventions

October 19-23, 2005 - Fort Worth, Texas

October 25-29, 2006 - Pittsburgh, Pennsylvania

Allegheny SAF Committee Chairs

Auditing*

Ronald J. Sheay
12 Glenwood Lane
Stockton, NJ 08559
(h) 609-397-7886

Awards*

Howard G. Wurzbacher
17374 N. Main Street Ext.
Titusville, PA 16354
(o) 814-484-9954
(h) 814-589-7538
hwurzbache@state.pa.us

Communications*

Ronald R. Farr, CF
6 Ricker Road
Newfoundland, NJ 07435
(o) 973-831-3358
(h) 973-208-8165
rfarr@njdwsc.com

Continuing Forestry Education Coordinator*

Mark Vodak
PO Box 231 Cook College
Rutgers University
New Brunswick, NJ 08903
(o) 732-932-8243
(h) 609-758-9449
vodak@aesop.rutgers.edu

Education Committee (ad hoc)

Mark R. Webb
11021 Route 6
Union City, PA 16438
(o/h) 814-663-5393
(f) 814-663-4008
mrkrwebb@earthlink.net

Education Endowment Fund (ad hoc)

Ronald J. Sheay
12 Glenwood Lane
Stockton, NJ 08559
(h) 609-397-7886

Forest History (ad hoc)

Ronald J. Sheay
(see above)

Forest Science Coordinator*

Mary Ann Fajvan
USFS NE Station
180 Canfield Street
Morgantown, WV 26505
(o) 304-285-1575
(h) 304-892-4515
mfajvan@fs.fed.us

Membership*

Kim C. Steiner
Forest Resources Lab
Penn State University
University Park, PA 16802
(o) 814-865-9351
(h) 814-234-8754

Nominations*

Ken Kane
103 Tionesta Avenue
Kane, PA 16735
(o) 814-837-9391
(h) 814-837-8357
(f) 814-837-9633

Policy & Legislative (PLAN)*

Timothy A. Kaden
724 Green Winged Trail
Camden, DE 19934
(o) 302-739-4811
(h) 302-697-7066

Program*

Ned R. Karger
305 Kinzua Avenue
Kane, PA 16735
(o) 814-837-6941
(h) 814-837-6819
(f) 814-837-8401
nkarger@collinsco.com

Student Coordinating (ad hoc)

Kim C. Steiner
Forest Resources Lab
Penn State University
University Park, PA 16802
(o) 814-865-9351
(h) 814-234-8754

Student Quiz Bowl

Steven F. Resh
Allegheny College of MD
12401 Willowbrook Road
Cumberland, MD 21502
(o) 301-784-5307
(h) 301-772-2834
sresh@allegheny.edu

Tellers*

Susan L. Stout
US Forest Service
PO Box 267
Irvine, PA 16329
(o) 814-563-1040
(h) 814-726-2023
ss Stout@ne_wa@fs.fed.us

*Standing Committees